

IR852ML

Aircraft Stand
Manoeuvring Guidance
and stop lighting
solution

Compliant to Latest International Standards*

- ▶ ICAO Annex 14. Vol 1
- ▶ FAA AC 150/5345-46†
- ▶ IEC 61827
- ▶ EASA
- ▶ Stannag 3316 (NATO)

Applications

CAT I/II/III all weather operation airfield ground
lighting (agl) systems.

* As applicable to the application, compliance with other civil aviation and
military regulations confirmed on request

† Electrical/Mechanical/Environmental characteristics only

Electrical Performance

Main Beam Aperture		Colour	Typical Power Consumption - Watts (VA) @ 6.6A				
Horiz(°)	Vert(°)		Per Beam Watts nominal	Fitting* Watts (VA) PF		Tx Primary** Watts (VA) PF	
0.0 to +359	1 to 90	Yellow	5.0	14.60 (14.69) 0.991		23.76 (24.66) 0.965	
0.0 to +359	1 to 90	Red	5.0	15.88 (16.05) 0.992		25.50 (26.34) 0.969	

* as measured at the input leads of the fixture.

** as measured across the primary winding of an appropriately sized isolation transformer with a total fixture and transformer secondary length not exceeding ~ 1.85m (72").

*** electrical characteristics measured with 45 watt transformer, fitting can operate from transformers up to 210 watts.

Note: Isolating transformer shall be suitably sized to accommodate specific secondary and other applicable losses.

Photometry

Specification

Aircraft stand manoeuvring guidance light.

ICAO Annex14 5.3.27.3

Colour Yellow

Typical Measured Values

Typical intensity at 5° 10 cds

Typical intensity at 10° 20 cds

Typical maximum intensity 45 cds

Specification

Aircraft stand manoeuvring stop light.

ICAO Annex14 5.3.27.35

Colour Red

Typical Measured Values

Typical intensity at 5° 10 cds

Typical intensity at 10° 20 cds

Typical maximum intensity 45 cds

Intensity Chart - IR852ML Aircraft Stand Manoeuvring light - Yellow

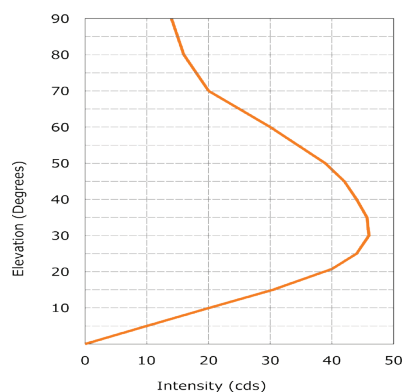

Intensity Chart - IR852ML Aircraft Stand Manoeuvring light - Red

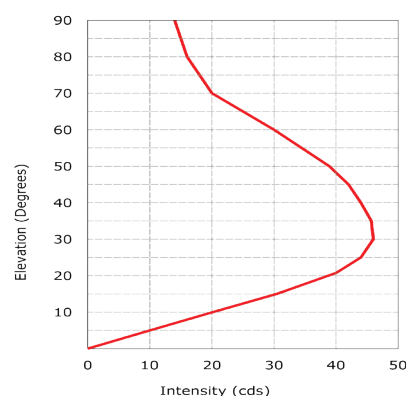

Key Features

- Low energy consumption.
- 6.6 amp version Steady light or dimmable dimmable lights, and full compatibility with existing airfield lighting series circuits.
- Low operating temperature, ensuring longer component life.
- Flush profile with gradient
- L-823 connectors on 6.6 amp version All other options supplied with 3 Core lead for connection into suitable JB or alternative IP68 Joint.
- Integral surge protection
- Steady or discrete dimming
- 100,000h service lifetime due to optimized electronics and thermal management
- Safety extra-low voltage compliant
- Enhanced surge current protection

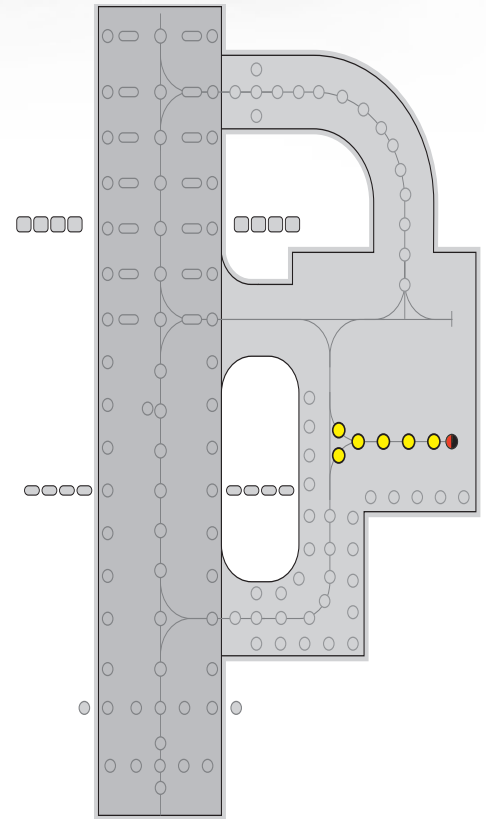

Environmental Conditions

- | | | | |
|-----------------------|------------------------------------|------------------------|----------------------------|
| ▶ Ambient Temperature | -55 °C to +55°C (-67 °F to +131°F) | ▶ Atmospheric Altitude | up to 10,000 feet (3000m) |
| ▶ Storage Temperature | -55°C to +70°C (-67 °F to +158°F) | ▶ Relative Humidity | 0-100% (sealed unit) |

Standards	
EMC protection	Immunity IEC 61000-4 Emission IEC 61000-2
Ingress protection class dust/liquids	IP66 (IEC69598-1)
Vibration resistance	IEC60068-2-6

IR852ML Aircraft Stand Manoeuvring Guidance



Ordering Codes:

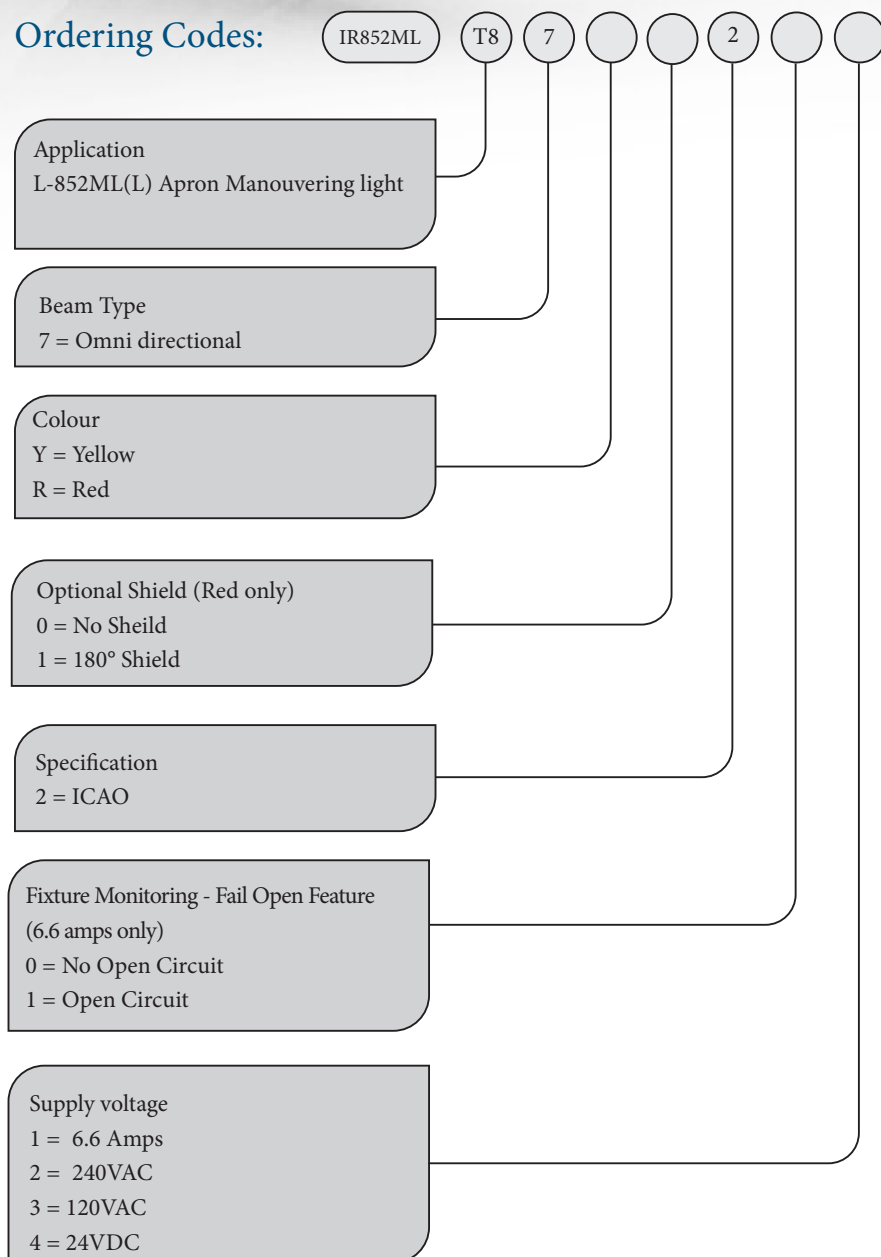

Beam Options

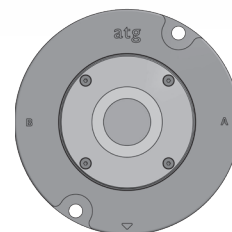

IR852ML
Omni-Directional

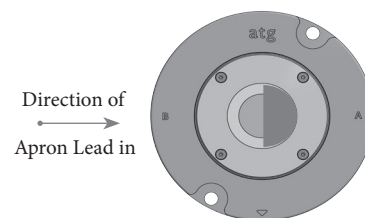

IR852ML
Uni-Directional

Electrical supply note:

Supply lead on 6.6 amp option is a standard FAA 2 pin plug.
An earthing point is available on the bottom cover.

All other options supplied with 3 Core lead for connection
into suitable JB or alternative IP68 Joint.

UK: +44 (0) 1942 68 5555 | USA: +1 (239) 985-9406

www.atgairports.com enquiries@atgairports.com sales-usa@atgairports.com

IR852ML

IR852ML Aircraft Stand Manoeuvring Guidance

Dimensions

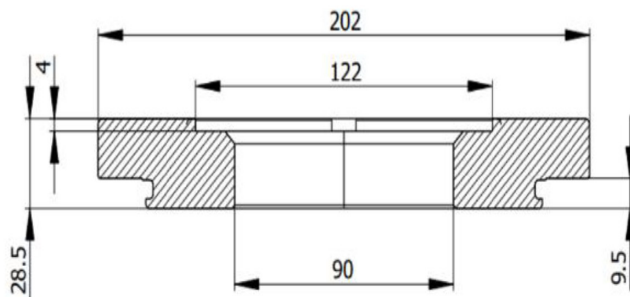
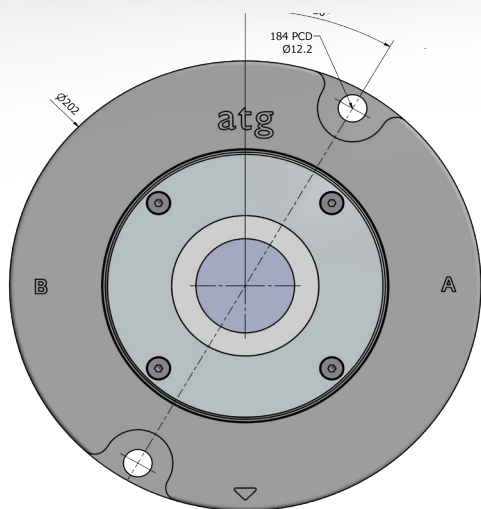

Fixture shown in 8" adaptor ring

Packaging

- Net weight 2.5Kg
- Gross weight 2.9 (boxed)
- Box 220mm (L) x 220mm (W) x 225mm (H)

weights and dimentions are nominal



Head Office:
atg airports ltd
Lowton Business Park | Newton Road
Lowton St. Mary's | Warrington
WA3 2AP | United Kingdom

atg airports reserve the right to change technical data and details at any point in time. Errors may have occurred



UK: +44 (0) 1942 68 5555 | USA: +1 (239) 985-9406

www.atgairports.com enquiries@atgairports.com sales-usa@atgairports.com

Rev 3 - 2023

IR852ML