

# AIB

## Airfield Identification Beacon

### Compliant to Latest International Standards

- ▶ ICAO Aerodromes -Annex 14 Volume 1, Par. 5.3.3 "Aeronautical Beacon"
- ▶ CE marking



### Applications

Airfield Identification Beacon used to assist the pilot to easily identify the airport from the air by use of flashing Airport IATA/ICAO Morse code.

## Features

According to Annex 14 of ICAO regulations, Aeronautical Beacons should be provided at airports intended for use at night.

An Identification Beacon shall be provided where the airport, due to the location or high background luminance, cannot be easily identified from the air by other identification means.

The light displays a white, green or yellow flashing light in the International Morse Code that identifies the airport, and ICAO or IATA Airport Letters can be used.

### Electrical Performance

- Power supply by external controller box
- Suitable for 24Vdc or 115/230Vac power supply
- LED supplied with constant current
- No RF - Radiations

### Optical Features

- Based on LED technology
- White / GREEN / yellow light 2.000cd, night mode
- Airport IATA/ICAO Morse Code Flash
- Horizontal beam radiation 360°
- Vertical beam spread -3° +1°
- PMMA lens
- Light output alignment device

### Mechanical Features - Light

- Anodised aluminium body, painted yellow
- Borosilicate glass cover protection
- Silicon rubber, VMQ
- Base wind collector and internal heat sink for optimum cooling
- Degree of protection: IP66
- Anti-condensation Gore-Tex valve
- Operating temp.: -30°C to +50°C
- Lamp unit weight: 6kg

### Mechanical Features - Control box

- Enclosure material: mild steel, painted RAL 7035
- Surge arrester
- Fault alarm
- Photocell (twilight sensor)
- Overvoltage protection

### Environmental Conditions

- ▶ Ambient Temperature -30°C to +50°C
- ▶ Storage Temperature -35°C to +65°C

- ▶ Atmospheric Altitude up to 10,000 feet ( 3000m)
- ▶ Relative Humidity 0-100% (sealed unit)

Ordering Codes: LS AIB

Airfield Identification Beacon

Standard

1 = ICAO

2 = IATA

Supply Voltage

1 = 220VAC

2 = 24VDC

Colour

W = White Flashing

G = Green Flashing

B = White / Green Flashing

Code

ICAO / IATA code (XXX)/(XXXX)

Other options available

Beacon support bracket

GPS (Global Position System) syncro

TWIN version: two separate LED circuits in the same fixture (normal + stand-by)



### Dimensions - Light unit

BEACON FRONT VIEW

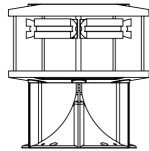

BEACON SIDE VIEW

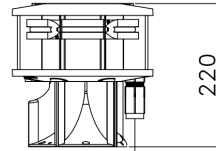

INCOMING POWER SUPPLY CABLE  
C/W CONNECTOR (CABLE O.D. 7/14mm, Max size 2.5sqmm)

BEACON TOP VIEW

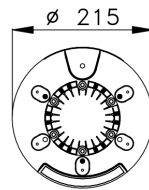

FIXING DETAILS

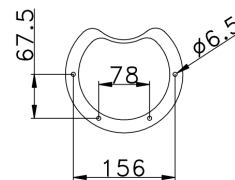

### Dimensions - Control box

TWILIGHT  
SENSOR

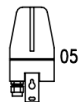

TO BE INSTALLED OUTSIDE  
LOOKING FREE SKY NORTH  
SUPPLIED AS LOOSE ITEM

FRONT VIEW

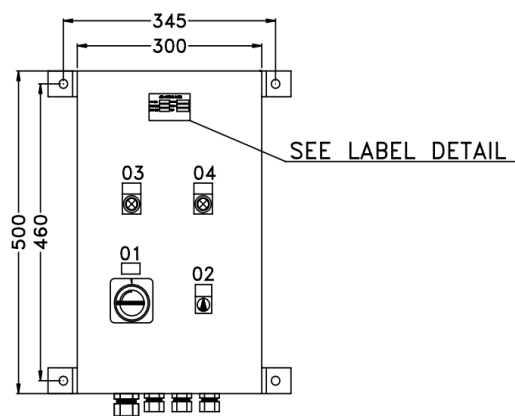

SIDE VIEW

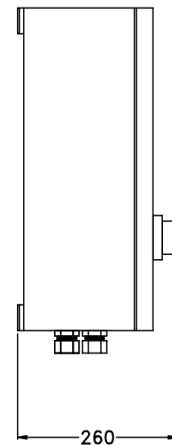

Head Office:  
atg airports ltd  
Lowton Business Park | Newton Road  
Lowton St. Mary's | Warrington  
WA3 2AP | United Kingdom

atg airports reserve the right to change technical data and details at any point in time. Errors may have occurred

**THINK  
BEFORE YOU  
PRINT**



UK: +44 (0) 1942 68 5555 | USA: +1 (239) 985-9406

[www.atgairports.com](http://www.atgairports.com) [enquiries@atgairports.com](mailto:enquiries@atgairports.com) [sales-usa@atgairports.com](mailto:sales-usa@atgairports.com)

Rev 1 - 2023

**AIB**