



# FX862WBA

Runway threshold  
wingbar

Elevated LED fixture

High intensity  
lighting solutions

## Compliant to Latest International Standards\*

- ▶ ICAO Annex 14, Vol 1
- ▶ FAA AC 150/5345-46†
- ▶ FAA Engineering Brief No.67
- ▶ TP312
- ▶ MOS139
- ▶ IEC 61827
- ▶ EASA
- ▶ Stannag 3316 (NATO)

## Applications

CAT I/II/III all weather operation airfield ground  
lighting (agl) systems.

\* As applicable to the application, compliance with other civil aviation and  
military regulations confirmed on request

† Electrical/Mechanical/Environmental characteristics only

# FX862WBA LED Elevated Threshold wingbar

## High intensity lighting solutions



### Electrical Performance

Main Beam Aperture		Colour	Typical Power Consumption - Watts (VA) @ 6.6A				
Horiz(°)	Vert(°)		Per Beam Watts nominal	Watts	Fitting* PF	Tx Primary** Watts	PF
-2 to +9	1 to 7	Green	22	24	0.98	24	0.98

Fixture Operational Current Range: 2.8 to 6.6A RMS

\* as measured at the input leads of the fixture.

\*\* as measured across the primary winding of an appropriately sized isolation transformer with a total fixture and transformer secondary length not exceeding - 1.85m (72").

\*\*\* electrical characteristics measured with 45 watt transformer, fitting can operate from transformers up to 100 watts.

Note: Isolating transformer shall be suitably sized to accommodate specific secondary and other applicable losses.

### Photometry

#### Specification

threshold / runway end ICAO Fig. A2-3, Fig. A2-8

#### Specification

Colour	Green
Max/Min Intensity ratio	<3.0
Main ellipse average intensity	10000cfs
Main ellipse minimum intensity	5000cfs
Second ellipse minimum intensity	1000cfs
Third ellipse minimum intensity	500cfs

#### Typical Measured Values

Colour	Green
Max/Min Intensity ratio	1.91
Main ellipse average intensity	10824cfs
Main ellipse maximum intensity	10436cfs
Main ellipse minimum intensity	4628cfs
Second ellipse minimum intensity	2035cfs
Third ellipse minimum intensity	1514cfs

Intensity Chart - Elevated Threshold runway end - Green

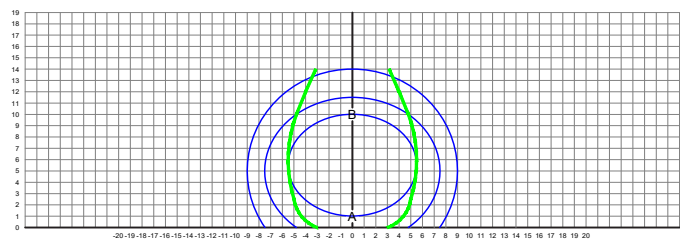

# FX862WBA LED Elevated Threshold wingbar

## High intensity lighting solutions

### Features

- Low energy consumption compared with the tungsten halogen equivalent.
- Greatly reduced maintenance: Estimated lamp life of 75,000 hours at 6.6A.
- Operates on the full range of 2.8A to 6.6A on either 3 or 5 step IGBT, ferroresonant or thyristor CCRs that are designed in compliance with IEC or FAA requirements. Fully dimmable lights, replicating the response curve of traditional halogen lights.
- Omnidirectional beam for circular guidance is available for bidirectional runway Edge fixture
- No need to replace the CCRs, series transformers, or cables. Full compatibility with existing airfield lighting series circuits. Installation on same mounting device as most conventional lights, for a straightforward replacement.
- Monitoring function of the individual light source. In case of a defect, the LED light automatically disconnects from the secondary side of the isolation transformer, resulting in an open circuit condition.
- Low operating temperature, ensuring longer component life.
- FAA L-823 connector
- Sealed cable entry to main assembly interface preventing insect and water ingress.
- powder coating, aviation yellow colour
- Integral surge protection

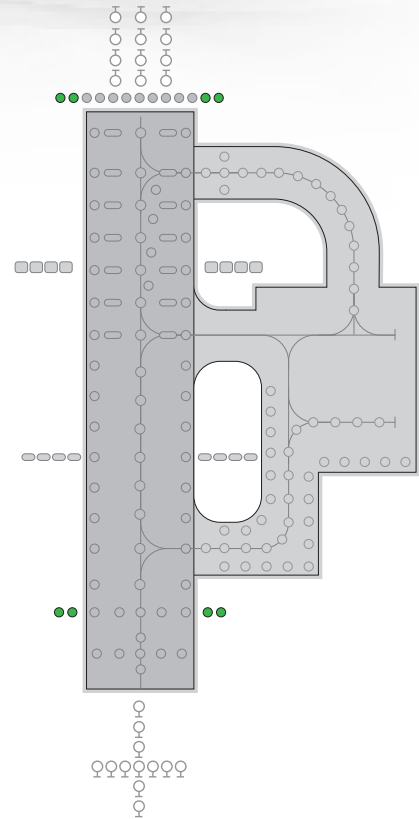

### Environmental Conditions

- ▶ Ambient Temperature -55 °C to +55°C (-67 °F to +131°F)
- ▶ Atmospheric Altitude up to 10,000 feet ( 3000m)
- ▶ Storage Temperature -55°C to +70°C (-67 °F to +158°F)
- ▶ Relative Humidity 0-100% (sealed unit)

Standards	
EMC protection	Immunity IEC 61000-4 Emission IEC 61000-2
Ingress protection class dust/liquids	IP67 (IEC69598-1)
Vibration resistance	IEC60068-2-6

# FX862WBA

LED Elevated Threshold wingbar  
High intensity lighting solutions



Ordering Codes: (FX) 862WBA 1 0 G N \_ 1

## Application

FX862WB(L) Threshold End

## Beam Type

### A Side

1 = Straight / Axial

### Beam Type

#### B Side

0 = Blank

## Colour

### A Side

G = Green

### B Side

N = Not applicable

## Specification

2 = ICAO

3 = MOS139

## Connections

1 = 1 x Bi-pin plug

## Beam Options

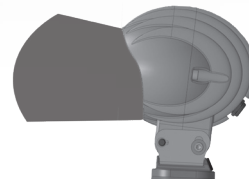

A

FX862WBA

Uni-directional



Additional optional features are  
available upon request

UK: +44 (0) 1942 68 5555 | USA: +1 (239) 985-9406

[www.atgairports.com](http://www.atgairports.com) [enquiries@atgairports.com](mailto:enquiries@atgairports.com) [sales-usa@atgairports.com](mailto:sales-usa@atgairports.com)

FX862WBA

# FX862WBA

LED Elevated Threshold wingbar  
High intensity lighting solutions

## Dimensions

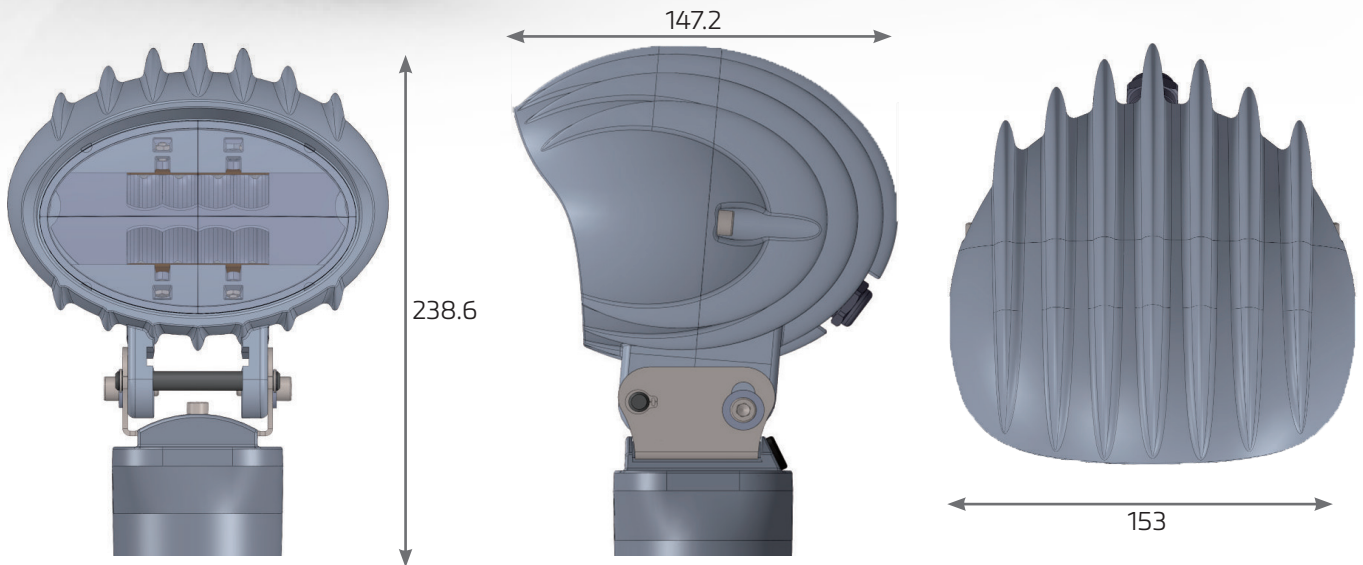

## Packaging

- ▶ Net weight 2.9Kg
- ▶ Gross weight 3.2 (boxed)
- ▶ Box 302mm (L) x 250mm (W) x 203mm (H)



### Head Office:

**atg airports Ltd**

Lowton Business Park | Newton Road  
Lowton St. Mary's | Warrington  
WA3 2AP | United Kingdom

atg airports reserve the right to change technical data and details at any point in time. Errors may have occurred



☎ UK: +44 (0) 1942 68 5555 | USA: +1 (239) 985-9406

🌐 [www.atgairports.com](http://www.atgairports.com) ✉ [enquiries@atgairports.com](mailto:enquiries@atgairports.com) ✉ [sales-usa@atgairports.com](mailto:sales-usa@atgairports.com)

FX862WBA