



FX852SK

Taxiway stopbar
Curved sections
High intensity
lighting solutions

Compliant to Latest International Standards*

- ▶ ICAO Annex 14. Vol 1
- ▶ FAA AC 150/5345-46[†]
- ▶ FAA Engineering Brief No.67
- ▶ TP312
- ▶ MOS139
- ▶ IEC 61827
- ▶ EASA
- ▶ Stannag 3316 (NATO)

Applications

CAT II/III all weather operation airfield ground
lighting systems.

* As applicable to the application, compliance with other civil aviation and
military regulations confirmed on request

[†] Electrical/Mechanical/Environmental characteristics only

FX852SK LED Inset Taxiway stopbar curved sections

High intensity lighting solutions



Electrical Performance

| Main Beam Aperture | | Colour | Typical Power Consumption - Watts (VA) @ 6.6A | | | | |
|--------------------|---------|---------|---|------------------------|-------|----------------------------|-------|
| Horiz(°) | Vert(°) | | Per Beam Watts nominal | Fitting* Watts (VA) | PF | Tx Primary** Watts (VA) | PF |
| -3.5 to +35 | 1 to 10 | RED/BLK | 8.33 | 18.28 (18.35) | 0.995 | 28.85 (29.69) | 0.972 |

Fixture Operational Current Range: 2.8 to 6.7A RMS

* as measured at the input leads of the fixture.

** as measured across the primary winding of an appropriately sized isolation transformer with a total fixture and transformer secondary length not exceeding - 1.85m (72").

*** electrical characteristics measured with 45 watt transformer, fitting can operate from transformers up to 210 watts.

Note: Isolating transformer shall be suitably sized to accommodate specific secondary and other applicable losses.

Photometry

Specification

Taxiway stopbar - curved ICAO Fig. A2-14

| | |
|--------------------------------|---------|
| Colour | Red |
| Max/Min Intensity Ratio | <3.0 |
| Main rect. average intensity | 100 cds |
| Main rect. minimum intensity | 50 cds |
| Second rect. minimum intensity | 10 cds |

Taxiway stopbar - curved ICAO Fig. A2-14

Stopbar - Curved Beam

| | |
|----------------------------------|---------|
| Colour | Red |
| Max/Min Intensity Ratio | 2.89 |
| Main rect. average intensity | 131 cds |
| Main rect. maximum intensity (A) | 182 cds |
| Main rect. minimum intensity (B) | 63 cds |
| Second rect. minimum intensity | 45 cds |

Intensity Chart - Taxiway stopbar straight (curved) Red

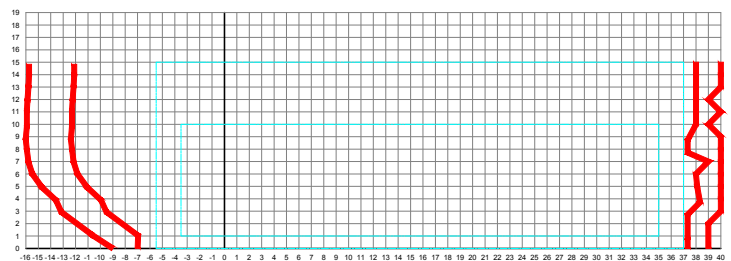

FX852SK LED Inset Taxiway stopbar curved sections

High intensity lighting solutions



Features

Low energy consumption compared with the tungsten halogen equivalent.

Greatly reduced maintenance: calculated MTBF of 75,000 hours at 6.6A.

Operates on the full range of 2.8A to 6.6A on either 3 or 5 step IGBT, ferroresonant or thyristor CCRs that are designed in compliance with IEC or FAA requirements.

Fully dimmable lights, replicating the response curve of traditional halogen lights.

Full compatibility with existing airfield lighting series circuits. Installation on same mounting device as most conventional lights, for a straightforward replacement.

Monitoring function of the individual light arrays for open circuit, short circuit, and over temperature. The LED light automatically disconnects from the secondary side of the isolation transformer, resulting in an open circuit condition.

Low operating temperature, ensuring longer component life.

FAA style 3, ICAO style 4 fixture with a 4.0 mm profile above gradient

L-823 connectors

Integral surge protection

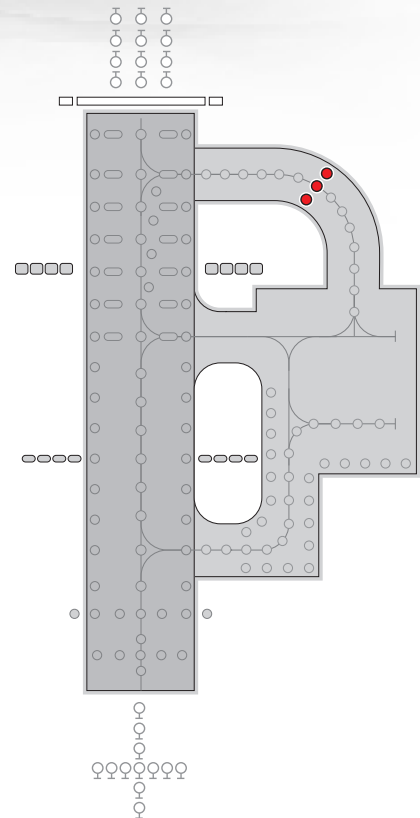

Environmental Conditions

► Ambient Temperature -55 °C to +55°C (-67 °F to +131°F)

► Storage Temperature -55°C to +70°C (-67 °F to +158°F)

► Atmospheric Altitude up to 10,000 feet (3000m)

► Relative Humidity 0-100% (sealed unit)

| Standards | |
|---------------------------------------|--|
| EMC protection | Immunity IEC 61000-4 Emission IEC 61000-2 |
| Ingress protection class dust/liquids | IP68 (IEC69598-1) |
| Vibration resistance | IEC60068-2-6 |
| | |
| | |
| | |

UK: +44 (0) 1942 68 5555 | USA: +1 (239) 985-9406

www.atgairports.com ✉enquiries@atgairports.com ✉sales-usa@atgairports.com

FX852SK(L)

FX852SK

LED Inset Taxiway stopbar curved sections
High intensity lighting solutions



Ordering Codes: (FX) 852SK8

Application

L-852SK(L) Taxiway stopbar curved sections

Beam Type

A Side

3 = Toe-in right
0 = Blank

B Side

2 = Toe in left
0 = Blank

Colour

A Side

R = Red
N = Not applicable

B Side

R = Red
N = Not applicable

Specification

Refer to front cover

Connections

1 = 1 x Bi-pin plug

Beam Options

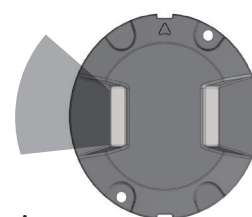

A

FX852SK

Uni-directional

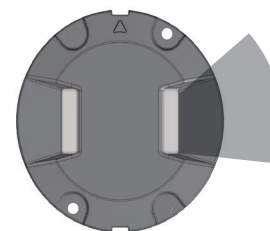

B

FX852SK

Uni-directional

Additional optional features may be available upon request

UK: +44 (0) 1942 68 5555 | USA: +1 (239) 985-9406

www.atgairports.com enquiries@atgairports.com sales-usa@atgairports.com

FX852SK(L)

FX852SK

LED Inset Taxiway stopbar curved sections
High intensity lighting solutions

Dimensions

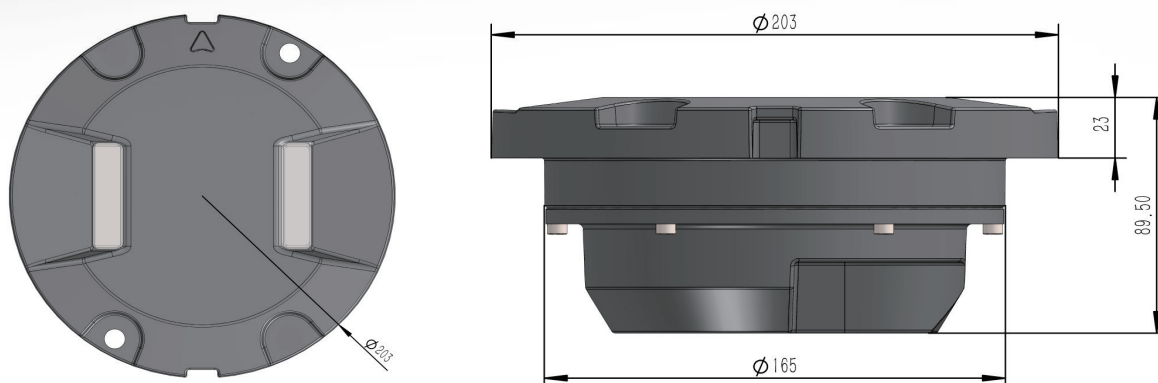

Packaging

- Net weight 2.5Kg
- Gross weight 2.9 (boxed)
- Box 220mm (L) x 220mm (W) x 225mm (H)

weights and dimensions are nominal



Head Office:

atg airports Ltd

Lowton Business Park | Newton Road

Lowton St. Mary's | Warrington

WA3 2AP | United Kingdom

atg airports reserve the right to change technical data and details at any point in time. Errors may have occurred



UK: +44 (0) 1942 68 5555 | USA: +1 (239) 985-9406

www.atgairports.com enquiries@atgairports.com sales-usa@atgairports.com

Rev 2 - 2020

FX852SK(L)