



Transformer & Lamp monitoring Mounting brackets

Applications

Mounting brackets are designed for various isolating transformers. The bracket, when installed in a pit, allows for the AGL isolating transformers to be kept out of any standing water, helping reduce water ingress. Separating the isolating transformers, also helps with circuit identification, thus reducing the amount of time spent fault finding.

The brackets also can be utilized for mounting transformer switching units and lamp control and monitoring devices.

Transformer Mounting Brackets



Ordering Codes:

10W - 150W transformer

5 5 0 0 1 1 0 0

150W - 300W transformer

5 5 0 0 1 1 0 1

Features:

Fabricated from 2mm thick hot rolled mild steel made to BS1449 standards.

Finished with 'Permasint' polypropylene alloy to protect against corrosion in harsh environments.

Available in two styles to suit the most commonly used transformer designs:

10W - 150W transformers

150W - 300W transformers

Also suitable for mounting lamp monitoring & switching units or switching transformer devices.

Overview

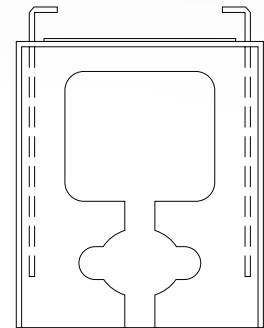

Holds up to a 150W transformer

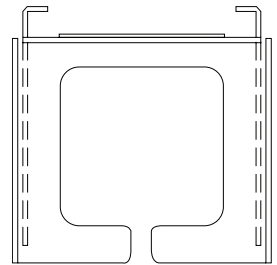

Holds up to a 300W transformer

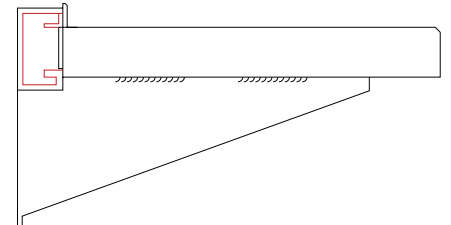

Mounted to channelling
(Unistrut or similar)



10W-150W Bracket

Transformer and TSU mounting

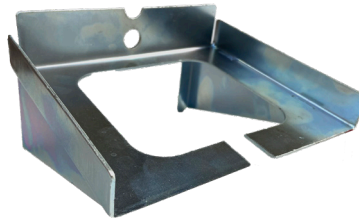

150W - 300W Bracket

Transformer mounting



Head Office:

atg airports Ltd

Lowton Business Park | Newton Road

Lowton St. Mary's | Warrington

WA3 2AP | United Kingdom

**THINK
BEFORE YOU
PRINT**



atg airports reserve the right to change technical data and details at any point in time. Errors may have occurred

UK: +44 (0) 1942 68 5555 | USA: +1 (239) 985-9406

www.atgairports.com enquiries@atgairports.com sales-usa@atgairports.com

Rev 2 - Feb 2022

Mounting
Brackets