



Mounting Base

Elevated Fixtures

Compliant to Latest
International Standards*

- ▶ FAA - Equipment not specified in FAA AC150/5345-46.

Applications

For the installation of elevated AGL light fixtures

* As applicable to the application

Mounting Base

Features

This mounting base consists of an aluminium casting that is secured to a hard standing at three points. An arch in the bottom of the base allows for an AGL secondary cable to be threaded through from the fixture to the AGL transformer. There is a facility on the base plate for an earth cable to be attached if required.

There is currently no regulation specifically covering the requirements for these types of mounting devices. However, the mounting base is designed to withstand stress of an atg airports manufactured fixture when exposed to a 300mph (482 km/h) wind.

The mounting device is designed to fit all atg airports light fixtures with appropriate coupling, easy to install, and almost maintenance free.



Environmental Conditions

▶ Ambient Temperature -55 °C to +55°C (-67 °F to +131°F)

▶ Atmospheric Altitude up to 10,000 feet (3000m)

▶ Storage Temperature -55°C to +70°C (-67 °F to +158°F)

Ordering Code:

009146

Dimensions

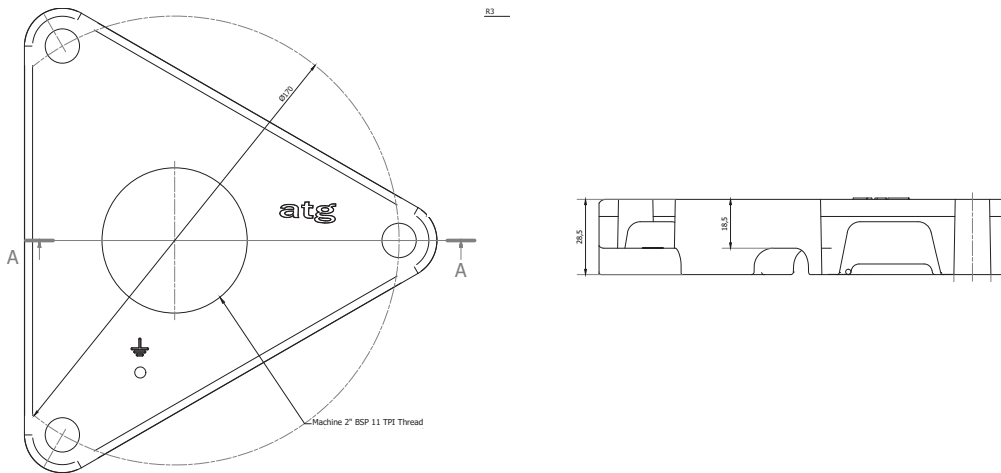

Head Office:

atg airports Ltd

Lowton Business Park | Newton Road

Lowton St. Mary's | Warrington

WA3 2AP | United Kingdom

**THINK
BEFORE YOU
PRINT**



atg airports reserve the right to change technical data and details at any point in time. Errors may have occurred

UK: +44 (0) 1942 68 5555 | USA: +1 (239) 985-9406

www.atgairports.com | enquiries@atgairports.com | sales-usa@atgairports.com