

LED technology

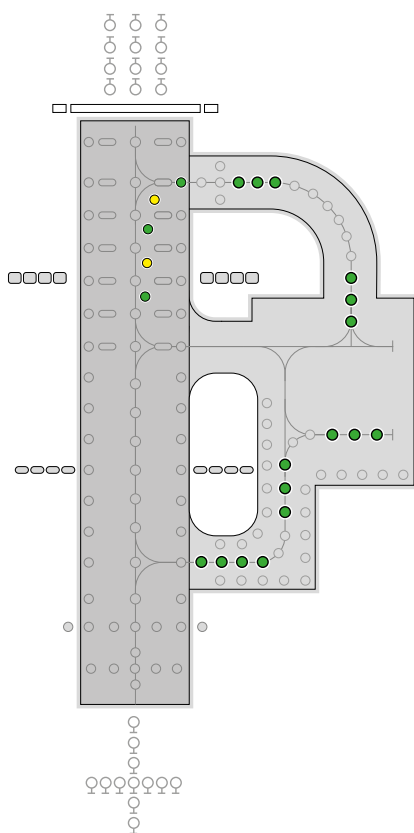

# IR852A

IRIS LED 8" taxiway centre line, straight sections (narrow), low intensity lighting solutions



## Applications

CAT I airfield ground lighting (agl) systems suitable for operations in RVR > 350m

## Compliant with Latest International Standards\*

- ▶ ICAO Annex 14. Vol 1
- ▶ FAA AC 150/5345-46
- ▶ FAA Engineering Brief No. 67
- ▶ IEC 61827
- ▶ EASA
- ▶ Stannag 3316 (NATO)
- ▶ MAA-MADS Issue 7, Fig 6-44

\* As applicable to the application, compliance with other civil aviation and military regulations confirmed on request

📞 UK: +44 (0) 1942 68 5555 | USA: 001 (239) 985-9406

🌐 [www.atgairports.com](http://www.atgairports.com) ✉ [products@atgairports.com](mailto:products@atgairports.com) ✉ [sales-usa@atgairports.com](mailto:sales-usa@atgairports.com)

IRIS LED AGL  
**L-852A**

# IR852A IRIS LED 8" taxiway centre line, straight sections (narrow), low intensity lighting solutions



## Electrical Performance

Main Beam Aperture		Colour	Typical Power Consumption - Watts (VA) @ 6.6A				
Horiz(°)	Vert(°)		Per Beam Watts	Fitting* Watts (VA)	PF	Tx Primary** Watts (VA)	PF
-10 to +10	1 to 4	GRN/GRN	1.38/1.38	12.94 (13.65)	0.947	33.64 (34.97)	0.967
-10 to +10	1 to 4	YEL/YEL	1.05/1.05	12.69 (12.86)	0.985	33.33 (33.83)	0.981
-10 to +10	1 to 4	GRN/YEL	1.38/1.05	12.98 (13.39)	0.969	34.13 (34.97)	0.974
-10 to +10	1 to 4	GRN/BLK	1.38/-	12.14 (12.21)	0.993	33.00 (33.82)	0.985
-10 to +10	1 to 4	YEL/BLK	1.05/-	11.70 (11.73)	0.996	32.80 (33.25)	0.986

Fixture Operational Current Range: 2.7 to 6.7A RMS

\* as measured at the input leads of the fixture.

\*\* as measured across the primary winding of 45W 6.6/6.6A sized isolation transformer with a total fixture and transformer secondary length not exceeding - 1.85m (72").

**Note:** Isolating transformer shall be suitably sized to accommodate specific secondary and other applicable losses.

For Bi-directional twin lead option use unidirectional electrical performance for each direction.

## Environmental Conditions

► Ambient Temperature -55 °C to +55°C (-67 °F to +131°F)

► Storage Temperature -55 °C to +55°C (-67 °F to +131°F)

► Ingress Protection IP67

## Photometry

### Specification

Taxiway Centreline Straight Narrow ICAO Fig 2.15 FAA L-852A

Colour	Green
Max/Min Intensity Ratio	<3.0
Main rect. average intensity	20 cds
Main rect. minimum intensity	10 cds
Second rect. minimum intensity	2 cds

### Typical Measured Values

Colour	Green
Max/Min Intensity Ratio	1.6
Main rect. average intensity	56 cds
Main rect. maximum intensity (A)	60 cds
Main rect. minimum intensity (B)	38 cds
Second rect. minimum intensity	31 cds

### Specification

Colour	Yellow
Max/Min Intensity Ratio	<3.0
Main rect. average intensity	20 cds
Main rect. minimum intensity	10 cds
Second rect. minimum intensity	2 cds

### Typical Measured Values

Colour	Yellow
Max/Min Intensity Ratio	2.0
Main rect. average intensity	42 cds
Main rect. maximum intensity (A)	56 cds
Main rect. minimum intensity (B)	28 cds
Second rect. minimum intensity	24 cds

Intensity Chart - IRIS Taxiway Centreline Luminaire (straight narrow) Green

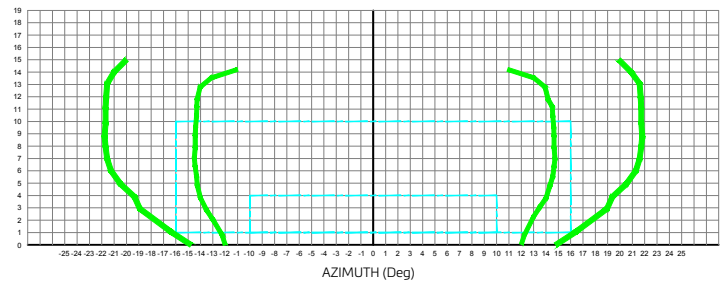

Intensity Chart - IRIS Taxiway Centreline Luminaire (straight narrow) Yellow

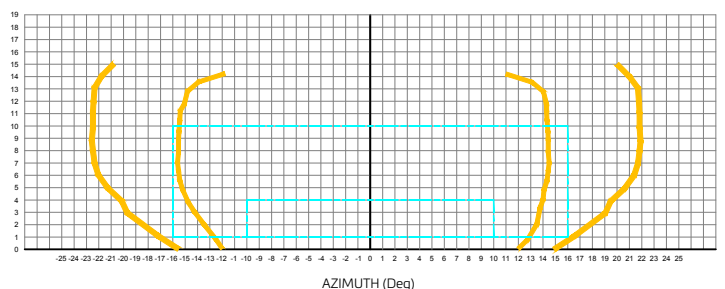

UK: +44 (0) 1942 68 5555 | USA: 001 (239) 985-9406

www.atgairports.com | products@atgairports.com | sales-usa@atgairports.com

IRIS LED AGL  
L-852A

# IR852A IRIS LED 8" taxiway centre line, straight sections (narrow), low intensity lighting solutions



## Ordering Codes IR852

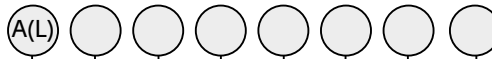

**Application**  
L-852A(L) Taxiway Centreline  
Straight (Narrow)

**Beam Type**  
**A Side**  
4 = Straight (Narrow)  
0 = Blank  
.....  
**B Side**  
4 = Straight (Narrow)  
0 = Blank

**Colour**  
**A Side**  
G = Green  
Y = Yellow  
C = Cyan/Green  
N = Not Applicable  
.....  
**B Side**  
G = Green  
Y = Yellow  
C = Cyan/Green  
N = Not Applicable

**Specification**  
1 = FAA  
2 = ICAO

**Connections**  
1 = 1 Bi Pin Plug  
2 = 2 Bi Pin Plug

**Fixture Monitoring - Fail Open Feature**  
0 = No Open Circuit  
1 = Open Circuit

## Beam Options

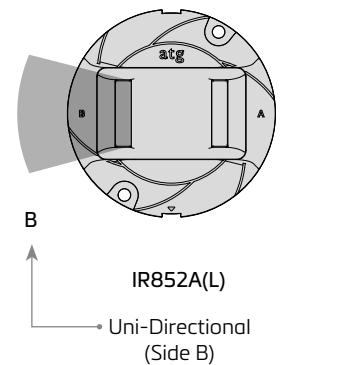
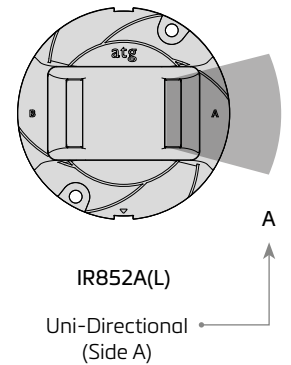
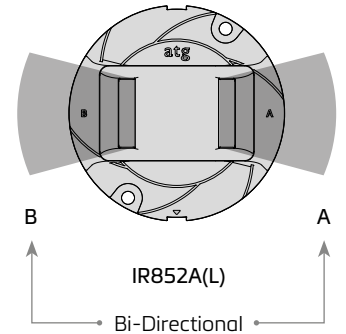

Additional optional features are available upon request

UK: +44 (0) 1942 68 5555 | USA: 001 (239) 985-9406

www.atgairports.com | products@atgairports.com | sales-usa@atgairports.com

IRIS LED AGL  
**L-852A**

# IR852A IRIS LED 8" taxiway centre line, straight sections (narrow), low intensity lighting solutions

## Dimensions

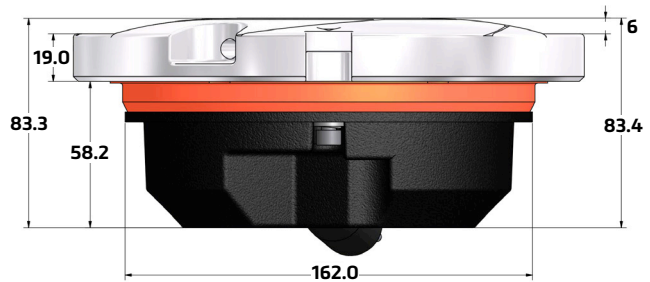
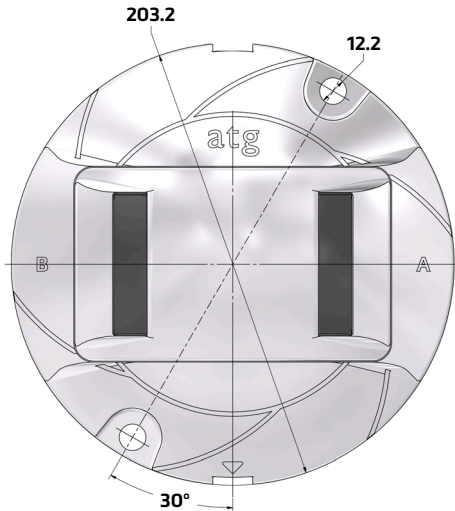

## Packaging

- ▶ Net weight 3.12Kg
- ▶ Gross weight 3.52kg (boxed)
- ▶ Box 260mm (L) x 260mm (W) x 175mm (H)

\*Dimensions are nominal

Consultants specification and installation information for the Iris range is available by request. Contact [marketing@atgairports](mailto:marketing@atgairports) for further details.

atg airports reserve the right to change technical data and details at any point in time. Errors may have occurred



### atg airports ltd

Lowton Business Park | Newton Road  
Lowton St. Mary's | Warrington  
WA3 2AP | United Kingdom

### atg airports inc

7857 Drew Circle #13  
Fort Myers | Florida 33967  
USA



UK: +44 (0) 1942 68 5555 | USA: 001 (239) 985-9406

[www.atgairports.com](http://www.atgairports.com) | [products@atgairports.com](mailto:products@atgairports.com) | [sales-usa@atgairports.com](mailto:sales-usa@atgairports.com)

IRIS LED AGL  
L-852A